

# Rack & Panel

## JF Series

## Miniature Side Mount / #20 Contacts / .040" Dia. / 7.5 Amps

### OUTLINE

Dimensions are for reference only and are subject to change. Outline drawings on request.

### Side Mounting, 4 Position Rectangular 2 and 4 Position In-Line

#### JF Series, PIN and Socket, 2 Position In-Line Connectors

Dimensions shown are typical for all standard 2 position in-line connectors.

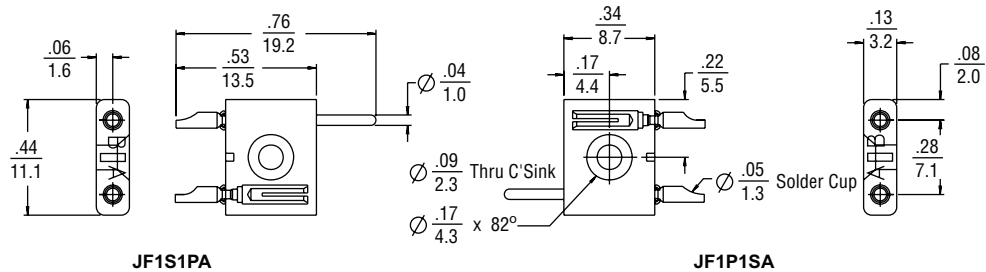

#### JF Series, PIN and Socket, 4 Position In-Line Connectors

Dimensions shown are typical for all standard 4 position in-line connectors.

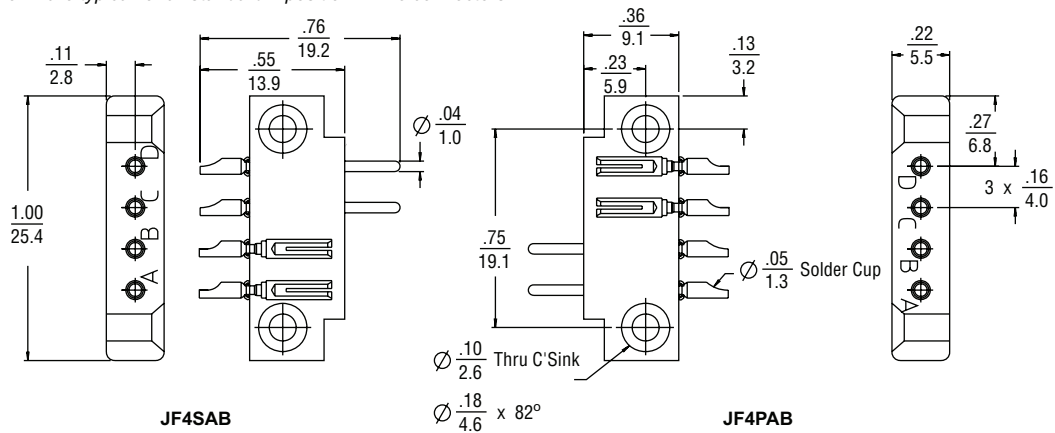

### Side Mounting, 4 Position Rectangular, 2 and 4 Position In-Line

#### JF Series, PIN and Socket, 4 Position Rectangular Connectors

Dimensions shown are typical for all standard 4 position rectangular connectors.

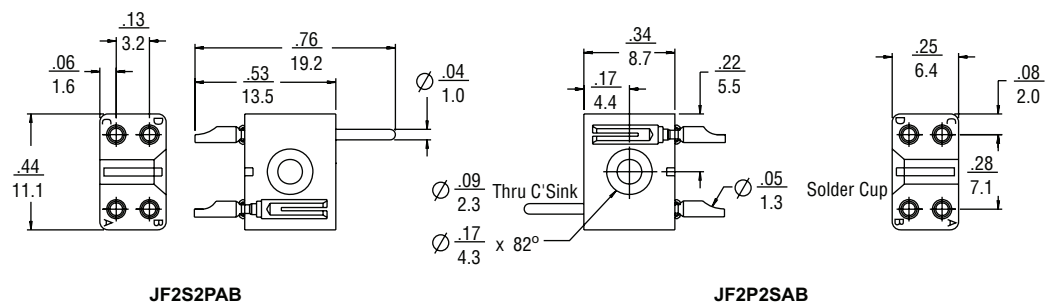

Winchester

62 Barnes Industrial Road North, Wallingford, Connecticut 06492 Phone:(203)741-5400 Fax:(203)741-5500 www.winchesterelectronics.com

# Rack & Panel

## JF Series

## Miniature Side Mount / #20 Contacts / .040" Dia. / 7.5 Amps

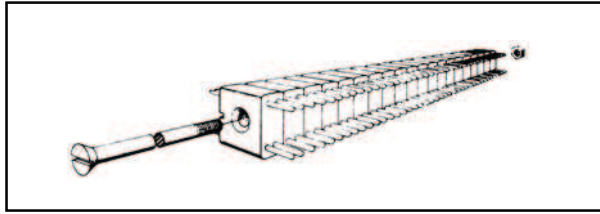

**JF-2P**  
20 connectors assembled

The versatile JF Series has a countersunk mounting hole and narrow width permitting exceptionally flat mounting. Maximum circuit density is provided with many positive polarizations. "Custom" multi-contact connectors are readily available by using the building block technique shown above.

### OUTLINE

Dimensions are for reference only and are subject to change. Outline drawings on request.

#### Typical Connector With DIP Solder Termination

JF Series connectors may be ordered with dip solder and right angle terminations. Consult factory for availability.

#### Straight Dip Solder

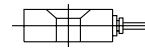

#### Right Angle Dip Solder

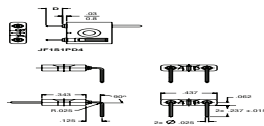
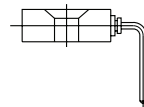

#### Typical Connectors Assemblies

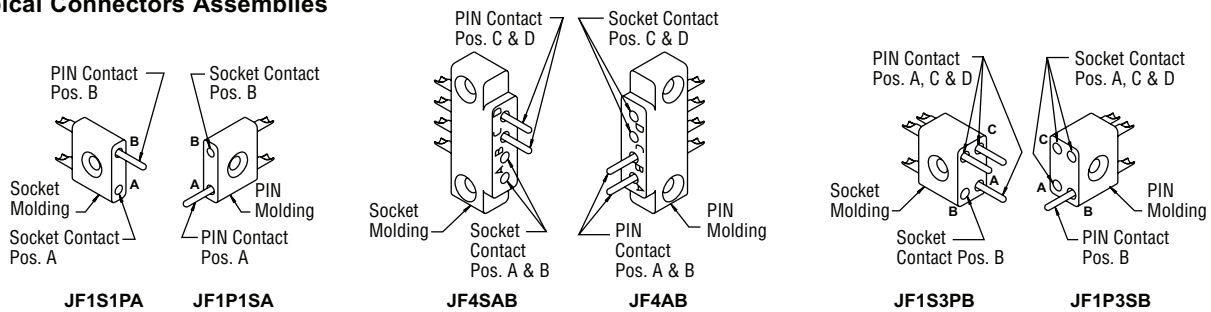

Winchester

62 Barnes Industrial Road North, Wallingford, Connecticut 06492 Phone:(203)741-5400 Fax:(203)741-5500 www.winchesterelectronics.com

### ORDERING INFORMATION

#### 2 Position In-Line Connector

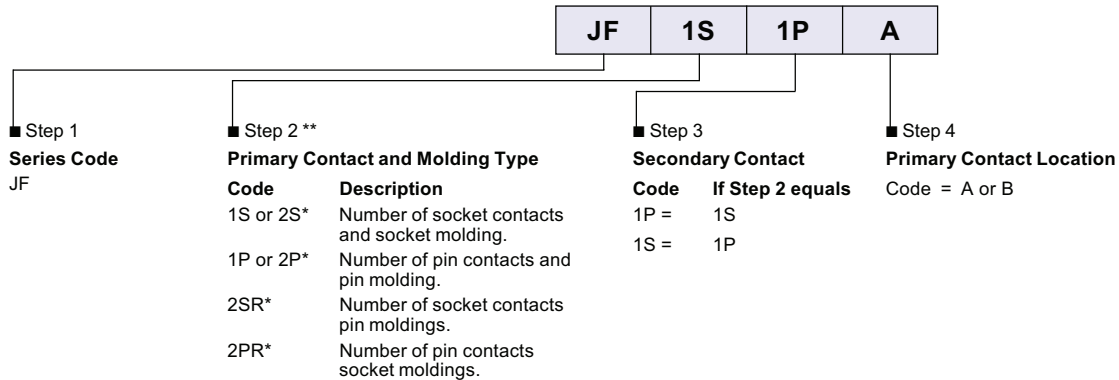

\*For two same type contacts, skip Steps 3 & 4.

#### 4 Position In-Line Connectors

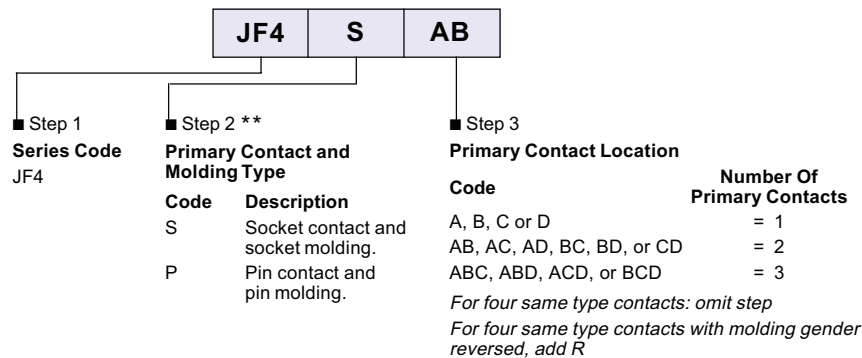

#### 4 Position Rectangular Connector

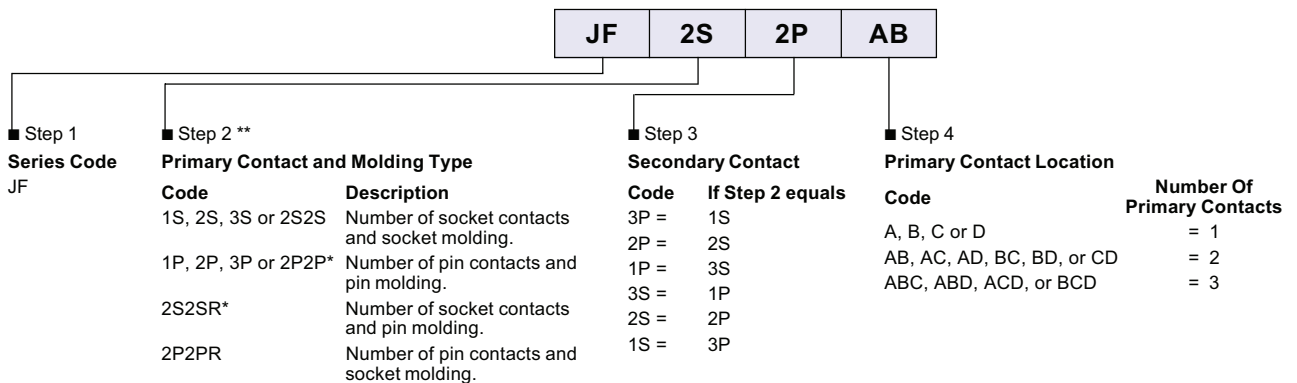

\*For four same type contacts, skip Steps 3 & 4.

\*\*For Pictorial Presentation, see RP/84 and RP/85

### SPECIFICATIONS

#### Materials

**Moldings (PIN and Socket):** Diallyl Orthophthalate  
**Pin Contacts:** .040 Brass, gold plated  
**Socket Contacts:** Phosphor bronze, gold plated

#### Performance Characteristics

**Dielectric Withstanding Voltage:** 1500 VAC (at sea level)  
**Current Rating:** 7.5 Amps  
**Operating Temperature Range:** -55°C to +125°C  
**Termination Type:** .050 dia. solder cup to accept #20 AWG stranded wire.